



COLOR/WATTAGE SELECTABLE 8 FT. TYPE B BALLAST BYPASS LED T8 TUBE
WARNING, CAUTION, SAFETY AND INSTALLATION INSTRUCTIONS

WARNING

- Installation, service, and maintenance of luminaires should be performed by a qualified licensed electrician.
- This LED retrofit installation requires knowledge of luminaires and electrical systems. If not qualified, do not attempt the installation, and contact a qualified electrician.
- Before installation, examine all parts that are not intended to be replaced by the lamp for damage and replace any damaged parts prior to installation of the lamp.

CAUTION

- Install this LED lamp in metal fixtures only.
- Do not use if outer lamp envelope is damaged or broken.
- Type B Lamp – Intended for use in fixtures with traditional fluorescent-type lampholders wired directly to the branch circuit. This includes both factory-wired fixtures, as well as these converted for this purpose under a retrofit program.
- Do not make or alter any open holes in the wiring enclosure or in any electrical components during lamp installation.
- This tube will not operate properly when connected to a standard (incandescent) dimmer or dimming control. Neither 1000Bulbs nor PLT offer compatible dimmers.
- Install this kit only in luminaires that have the construction features and dimensions shown in the photographs and/or drawings and where the input rating of the retrofit kits does not exceed the input rating of the luminaire.
- The lamps covered by this report are intended to retrofit surface mount, Type IC or non-IC recessed mounted Listed fluorescent luminaires that use a maximum of 2 tubular lamps. The minimum lamp compartment dimensions are tabulated below:

Model Number	Minimum Lamp Compartment Dimensions (Length x Width x Height) [in]	Max No.
PLTSPF1216	96.06 x 10.63 x 2.76	2

NOTICE

- Suitable for use with the following emergency equipment: Precision Lighting & Transformer, Inc., model PLTSP92.
- This lamp is accepted as a component of a luminaire where the suitability of the combination shall be determined by authorities having jurisdiction. Product must be installed by a qualified electrical in accordance with the applicable and appropriate electrical codes. The installation guide does not supersede local or national regulations for electrical installations.

Cap Adaptor Replacement

If you need to use the R17D cap, follow these steps:

1. Take out tube with original Fa8 cap.
2. Pull out the Fa8 cap adaptor at both ends.





COLOR/WATTAGE SELECTABLE 8 FT. TYPE B BALLAST BYPASS LED T8 TUBE WARNING, CAUTION, SAFETY AND INSTALLATION INSTRUCTIONS

3. Align the end pins with the pin holes of the R17d cap adaptor. Plug in R17d cap adaptor at both ends.

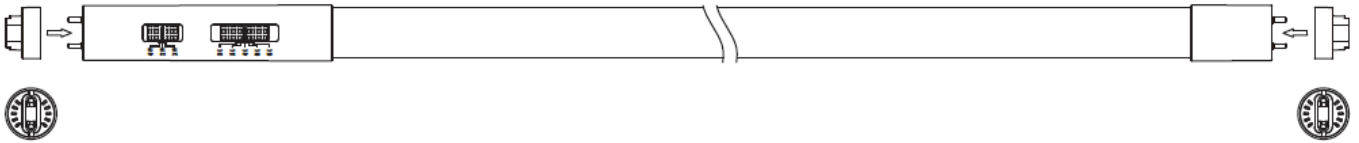

4. Replacement complete.



Wiring Diagrams – Fa8

Electronic Ballast

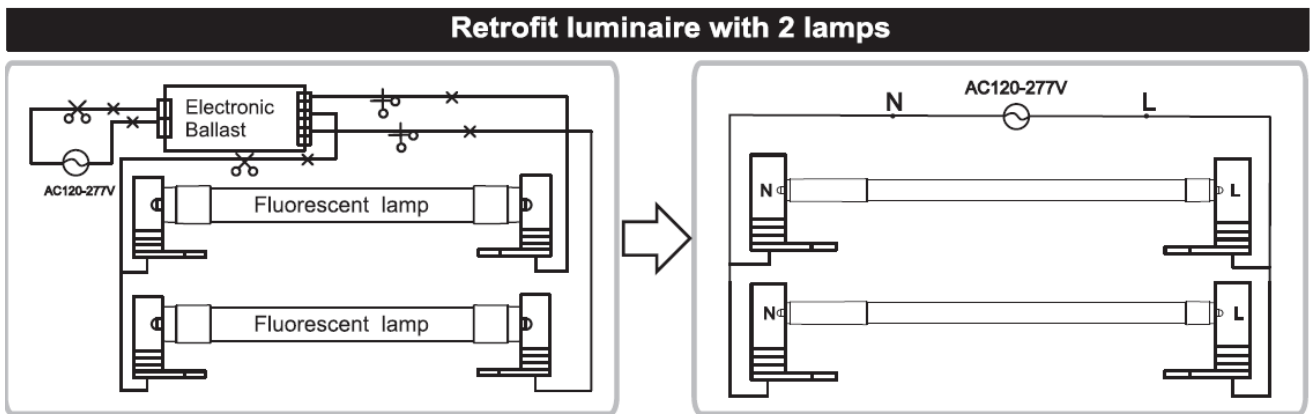
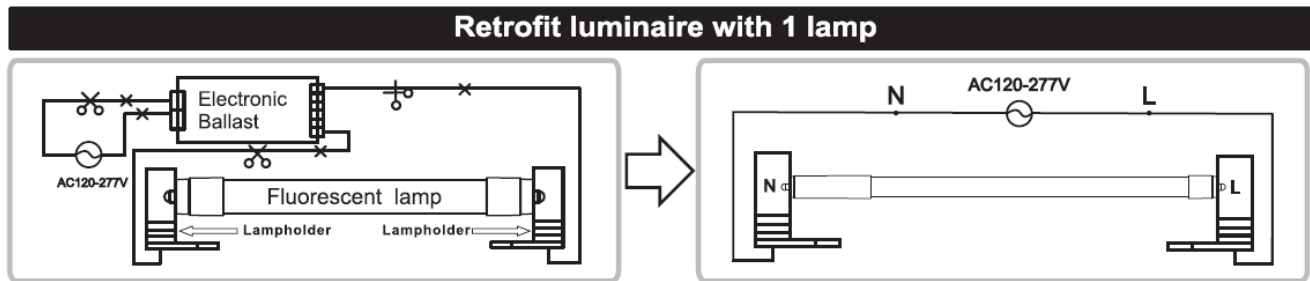

Magnetic Ballast

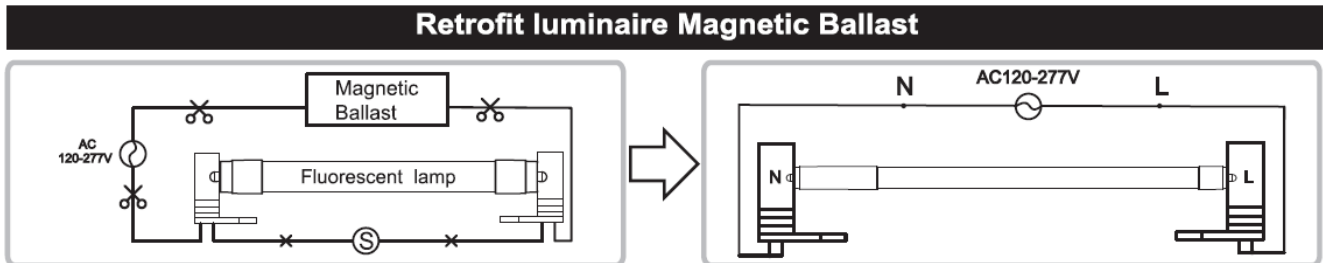



Wiring Diagrams – R17d

Electronic Ballast

Retrofit luminaire with shunted lampholders — 1 lamp

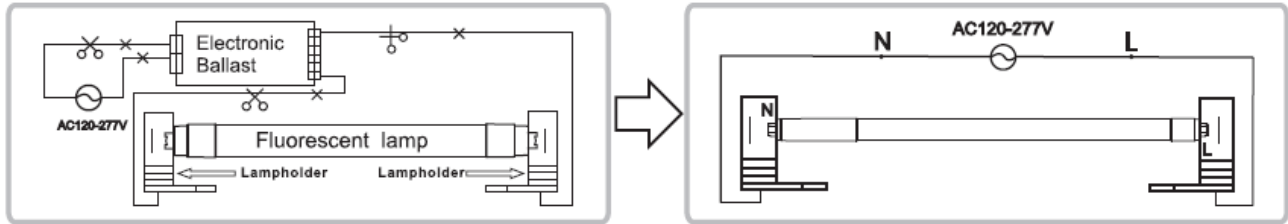

Retrofit luminaire with shunted lampholders — 2 lamps

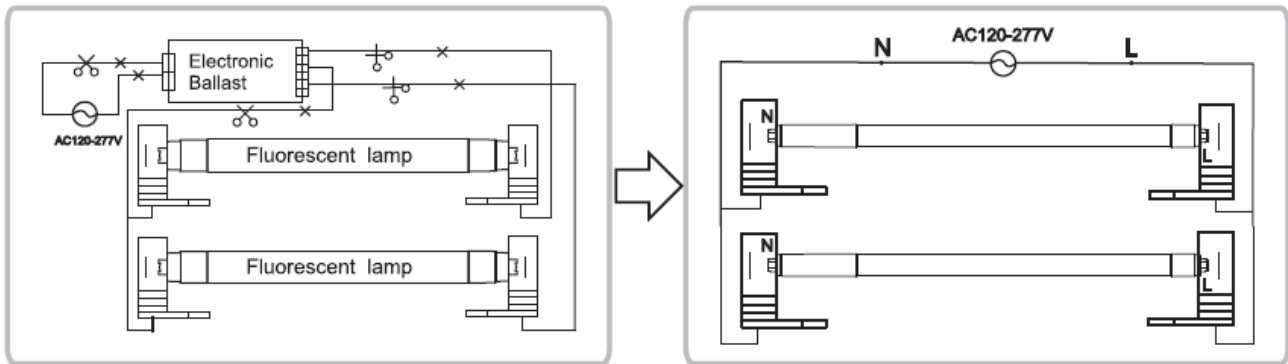

Retrofit luminaire with non-shunted lampholders — 1 lamp

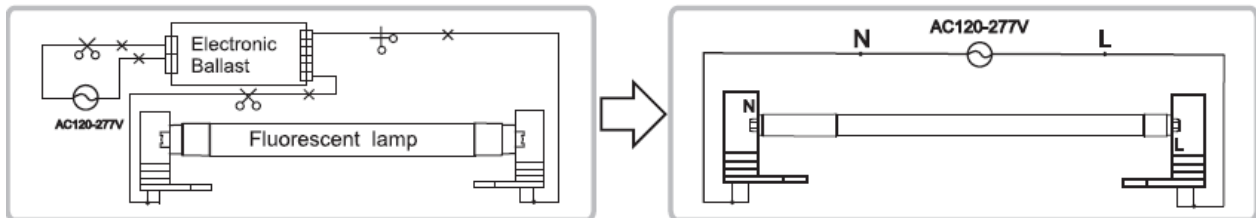

Retrofit luminaire with non-shunted lampholders — 2 lamps

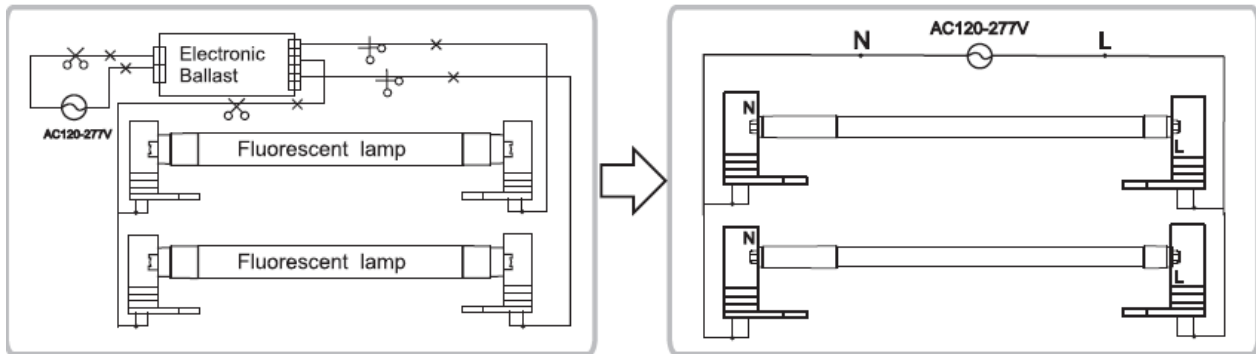



COLOR/WATTAGE SELECTABLE 8 FT. TYPE B BALLAST BYPASS LED T8 TUBE

WARNING, CAUTION, SAFETY AND INSTALLATION INSTRUCTIONS

Magnetic Ballast

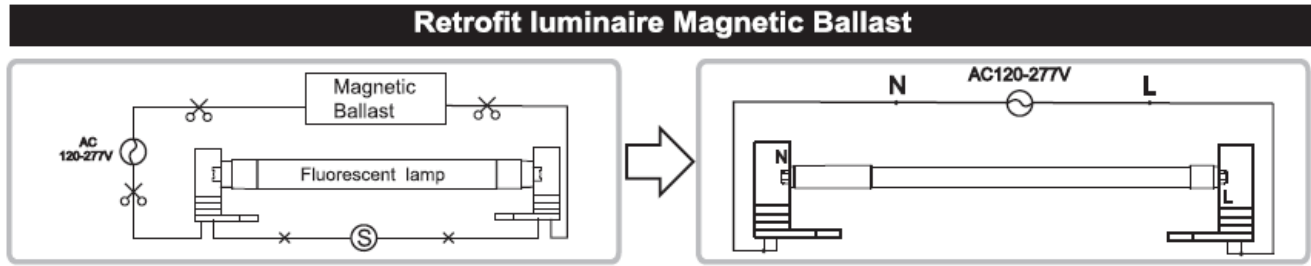

Selectable Switches

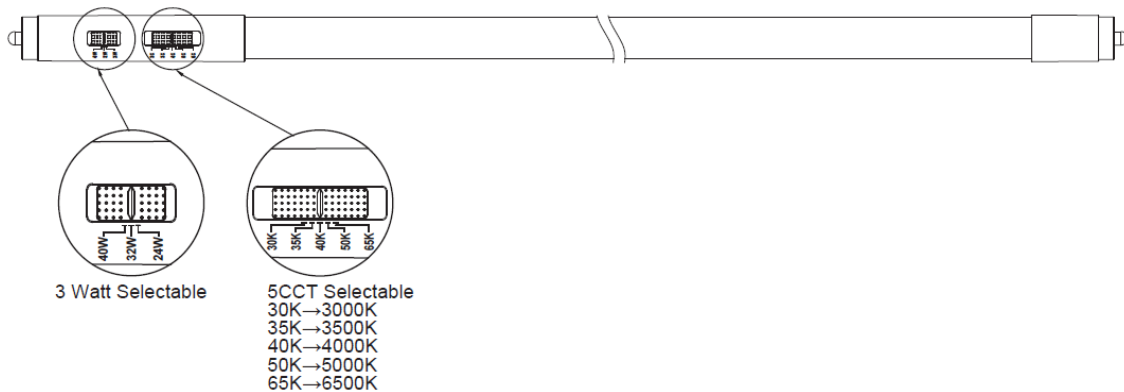

FCC Warning

- When installed as a ballast bypass lamp, this device complies with Part 15 of the FCC rules. Operation is subject to the following two conditions: (1) this device may not cause harmful interference, and (2) this device must accept any interference received, including interference that may cause undesired operation.

⚠ WARNING

- Before installing, servicing, or performing routine maintenance upon this equipment, follow these general precautions.
- To reduce the risk of death, personal injury, or property damage from fire, electric shock, falling parts, cuts/abrasions, and other hazards, read all warnings and instructions included with and on the fixture box and all fixture labels.
- Proper grounding is required to ensure safety.
- Power must be turned off at the breaker before installation or maintenance.
- This product must be installed in accordance with the applicable installation code by a person familiar with the construction and operation of the product and the hazards involved.
- Wear gloves and eye protection at all times while installing, servicing, or performing maintenance on the luminaire, and avoid direct eye exposure to the light source while it is on.
- To prevent wiring damage or abrasion, do not expose wiring to edges of sheet metal or other sharp objects.
- Do not install damaged product. Inspect luminaire for damage that may have occurred during transit. If damaged, contact the manufacturer immediately.



COLOR/WATTAGE SELECTABLE 8 FT. TYPE B BALLAST BYPASS LED T8 TUBE WARNING, CAUTION, SAFETY AND INSTALLATION INSTRUCTIONS

- These instructions do not purport to cover all details or variations in equipment nor to provide every possible contingency to meet in connection with installation, operation, or maintenance. Should further information be desired or should particular problems arise which are not covered sufficiently for the purchaser's or owner's purposes, contact the manufacturer.

⚠ ADVERTENCIA

- Antes de instalar, reparar o realizar el mantenimiento de rutina de este equipo, siga estas precauciones generales.
- Para reducir el riesgo de muerte, lesiones personales o daños a la propiedad por fuego, descarga eléctrica, caída de piezas, cortes / abrasiones y otros peligros, lea todas las advertencias y instrucciones incluidas con y en la caja del dispositivo y todas las etiquetas del dispositivo.
- Se requiere una conexión a tierra adecuada para garantizar la seguridad.
- Se debe apagar la energía en el disyuntor antes de la instalación o el mantenimiento.
- Este producto debe ser instalado de acuerdo con el código de instalación aplicable por una persona familiarizada con la construcción y operación del producto y los peligros involucrados.
- Utilice guantes y protección para los ojos en todo momento durante la instalación, el servicio o el mantenimiento de la luminaria, y evite la exposición directa de los ojos a la fuente de luz mientras está encendida.
- Para evitar daños o abrasiones en el cableado, no exponga el cableado a bordes de láminas de metal u otros objetos afilados.
- No instale un producto dañado. Inspeccione la luminaria en busca de daños que puedan haber ocurrido durante el tránsito. Si está dañado, comuníquese con el fabricante de inmediato.
- Estas instrucciones no pretenden cubrir todos los detalles o variaciones en el equipo ni proporcionar todas las posibles contingencias a cumplir en relación con la instalación, operación o mantenimiento. Si desea obtener más información o si surgen problemas particulares que no están suficientemente cubiertos para los propósitos del comprador o propietario, comuníquese con el fabricante.