

DESCRIPTION

Customize the brightness and color of lighting in your space by installing these wattage and color selectable Spec Grade LED downlight fixtures in their compatible trims. Each engine's junction box eliminates the need for traditional housing, making it an ideal choice for hardwired lighting in new constructions and remodels.

FEATURES

- Energy efficient replacement for 120W and 150W incandescent fixtures (PLT-90287 & PLT-90288), or 150W metal halide fixtures (PLT-90536)
- Light output will vary depending on the wattage selected, see Selectable Table for more information
- Can be paired with 4, 6, 8, or 10-inch aperture round or square aluminum trims (sold separately); see Compatible Trims section for list of compatible trims
- Does not require a recessed housing
- Can be paired with optional mounting plates for new construction; see Mounting Accessories section for list of compatible mounting plates
- Dimmable with 0-10V dimmers
- Wattage and color temperature can be adjusted via switches on the side of the fixture; see installation instructions for more information

LISTINGS

- UL Listed for damp locations
- IC Rated (PLT-90287 only)
- Energy Star Certified

PERFORMANCE

- CRI: 80
- CCT: 3000K, 3500K, and 4000K
- Rated Lifetime L70: 60,000 hours

ELECTRICAL

- THD: <20%
- Power Factor: >0.9
- Input Voltage: 120-277V (PLT-90536 only), 120-347V
- Surge protection: 1000V

THERMAL

- -4°F to 104°F (-20°C to 40°C) operating temperature

Project name	Type
Catalog number	
Comments	Voltage
Approved by	Date



CONSTRUCTION

- Aluminum body
- Frosted PMMA lens

WARRANTY

- 5-year limited warranty; see pltsolutions.com for warranty details

APPLICATIONS

- Offices
- High-end Restaurants
- Conference Rooms
- Living Rooms
- Lobbies
- Hallways
- High-end Hotels

PERFORMANCE	Power Consumption*	10, 15, 20, 27, 34, 40, 50, 60 Watt
	CRI	80
	CCT*	3000K, 3500K, 4000K
ELECTRICAL	LED L70 Life Hours	60,000
	Power Factor	>0.9
	THD	<20%
CONSTRUCTION	Input Voltage	120-277V, 120-347V
	Housing	Aluminum
	Lens	Frosted
LISTINGS	Certifications	UL Listed, IC, Energy Star Certified
	Environment	Damp Location Rated

* See Selectable Table for full breakdown

PERFORMANCE SUMMARY

Item #	UPC	Size	Wattage*	CCT*	Voltage	Replaces	CRI	LED L70 Life Hours	Dimmable	IC Rated	Default Setting	Energy Star
PLT-90287	842821119970	4"	10/ 15/ 20	3000K/ 3500K/ 4000K	120-347V	120W Incan.	80	60,000	Yes	Yes	20W, 3500K	PLTRC111#
PLT-90288	842821119987	4"	27/ 34/ 40	3000K/ 3500K/ 4000K	120-347V	150W Incan.	80	60,000	Yes	No	40W, 3500K	PLTRC211#
PLT-90536	842821134324	6"	40/ 50/ 60	3000K/ 3500K/ 4000K	120-277V	150W MH	80	>50,000	Yes	No	60W, 3500K	PLTRC512#

*See Selectable Table for full breakdown

SELECTABLE TABLE

Item #	Wattage	CCT	Lumens	Efficacy
PLT-90287	10	3000K	740	74
		3500K	770	77
		4000K	800	80
	15	3000K	1065	71
		3500K	1125	75
		4000K	1170	78
	20	3000K	1380	69
		3500K	1440	72
		4000K	1500	75
PLT-90288	27	3000K	2685	99
		3500K	2882	106
		4000K	2787	103
	34	3000K	3206	94
		3500K	3366	99
		4000K	3298	97
	40	3000K	3587	89
		3500K	3844	96
		4000K	3711	92
PLT-90536	40	3000K	4478	112
		3500K	4672	117
		4000K	4594	115
	50	3000K	5512	110
		3500K	5803	116
		4000K	5648	113
	60	3000K	6431	107
		3500K	6803	113
		4000K	6568	109

COMPATIBLE TRIMS

Item #	Description	Compatible Fixtures
PLT-90289	4" Aperture Round Trim - White finish with Matte Silver Reflector	PLT-90287, PLT-90288
PLT-90290	6" Aperture Round Trim - White finish with Matte Silver Reflector	PLT-90287, PLT-90288, PLT-90536
PLT-90291	8" Aperture Round Trim - White finish with Matte Silver Reflector	PLT-90287, PLT-90288, PLT-90536
PLT-90292	10" Aperture Round Trim - White finish with Matte Silver Reflector	PLT-90287, PLT-90288, PLT-90536
PLT-90333	4" Aperture Square Trim - White finish with Matte Silver Reflector	PLT-90287, PLT-90288
PLT-90334	6" Aperture Square Trim - White finish with Matte Silver Reflector	PLT-90287, PLT-90288
PLT-90335	4" Aperture Wall Wash Square Trim - White finish with Matte Silver Reflector	PLT-90287, PLT-90288
PLT-90336	6" Aperture Wall Wash Square Trim - White finish with Matte Silver Reflector	PLT-90287, PLT-90288
PLT-90337	4" Aperture Wall Wash Round Trim - White finish with Matte Silver Reflector	PLT-90287, PLT-90288
PLT-90338	6" Aperture Wall Wash Round Trim - White finish with Matte Silver Reflector	PLT-90287, PLT-90288
PLT-90537	6" Aperture Round Trim - White finish with Matte Silver Reflector	PLT-90287, PLT-90288, PLT-90536
PLT-90538	8" Aperture Round Trim - White finish with Matte Silver Reflector	PLT-90287, PLT-90288, PLT-90536

MOUNTING ACCESSORIES

Item #	Description	Compatible Light Engines	Compatible Trims
PLT-90387	3" to 8" Round Mounting Plate - for New Construction	PLT-90287, PLT-90288, PLT-90536	PLT-90288, PLT-90290, PLT-90291, PLT-90537, PLT-90538
PLT-90388	4" to 6" Square Mounting Plate - for New Construction	PLT-90287, PLT-90288	PLT-90333, PLT-90335, PLT-90336
PLT-90600	3" to 8" Round Mounting Plate - for New Construction	PLT-90287, PLT-90288, PLT-90536	PLT-90289, PLT-90290, PLT-90291, PLT-90537, PLT-90538

DOWNLIGHT ENGINE DIMENSIONS

PLT-90287:

Height - 3.46"

Diameter - 4.14"

Weight - 1.03 lbs

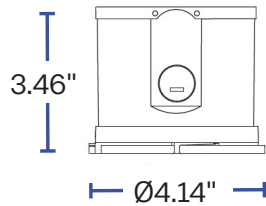

PLT-90288:

Height - 4.96"

Diameter - 4.14"

Weight - 1.62 lbs

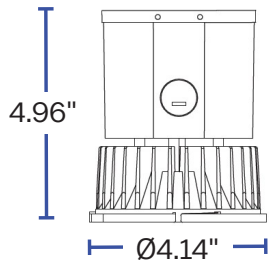

PLT-90536:

Height - 5.36"

Diameter - 5.35"

Weight - 2.17 lbs

ROUND TRIM DIMENSIONS

PLT-90289:

Inside Diameter – 4"

Outside Diameter – 5.5"

Height – 2.8"

Hole Cut Size – 4.7" to 5.2"

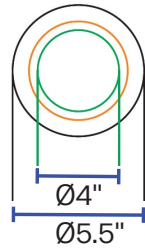

PLT-90290:

Inside Diameter – 5.6"

Outside Diameter – 7.9"

Height – 2.5"

Hole Cut Size – 6" to 7.3"

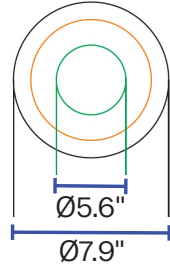

PLT-90291:

Inside Diameter – 7"

Outside Diameter – 9.25"

Height – 3.25"

Hole Cut Size – 7.2" to 8.9"

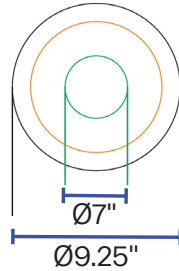

PLT-90292:

Inside Diameter – 9"

Outside Diameter – 11"

Height – 4.3"

Hole Cut Size – 9.5" to 10.8"

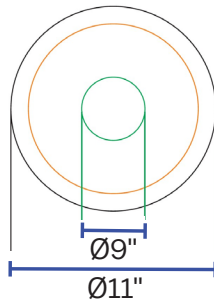

PLT-90537:

Inside Diameter – 5.6"

Outside Diameter – 7.62"

Height – 2.5"

Hole Cut Size – 6" to 7.3"

PLT-90538:

Inside Diameter – 7"

Outside Diameter – 9.2"

Height – 3.11"

Hole Cut Size – 7.4" to 8.9"

SQUARE TRIM DIMENSIONS

PLT-90333:

Inside Width – 4.1"
 Inside Length – 4.1"
 Inside Opening Diameter – 3.3"
 Outside Width – 6.4"
 Outside Length – 6.4"
 Height – 2.52"
 Hole Cut Size - 5.3" to 6"

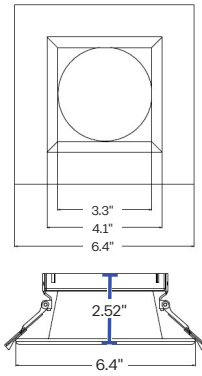

PLT-90334:

Inside Width – 5.6"
 Inside Length – 5.6"
 Inside Opening Diameter – 3.3"
 Outside Width – 7.4"
 Outside Length – 7.4"
 Height – 2.5"
 Hole Cut Size - 6" to 7.3"

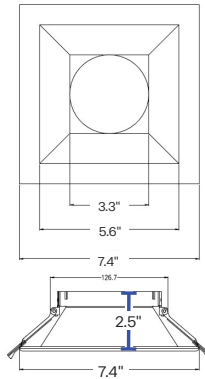

WALL WASH TRIM DIMENSIONS

PLT-90337:

Inside Diameter – 4"
 Inside Opening Diameter – 3.3"
 Outside Diameter – 6.4"
 Height – 2.8"
 Hole Cut Size – 4.7" to 5.2"

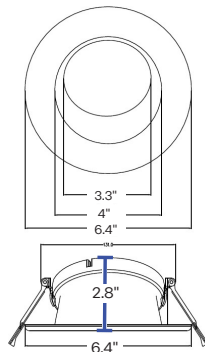

PLT-90335:

Inside Width – 4.1"
 Inside Length – 4.1"
 Inside Opening Diameter – 3.3"
 Outside Width – 6.4"
 Outside Length – 6.4"
 Height – 2.80"
 Hole Cut Size - 5.3" to 6"

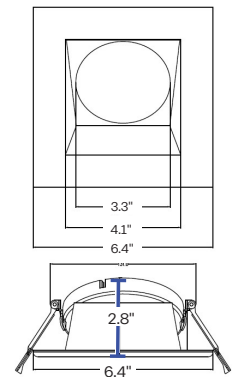

PLT-90338:

Inside Diameter – 5.8"
 Inside Opening Diameter – 3.3"
 Outside Diameter – 7.5"
 Height – 3.1"
 Hole Cut Size – 6" to 7.3"

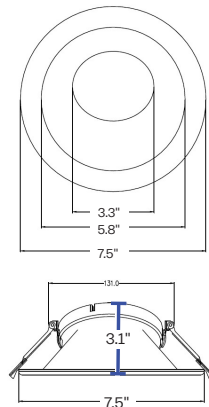

PLT-90334:

Inside Width – 5.8"
 Inside Length – 5.8"
 Inside Opening Diameter – 3.3"
 Outside Width – 7.4"
 Outside Length – 7.4"
 Height – 3.1"
 Hole Cut Size - 6" to 7.3"

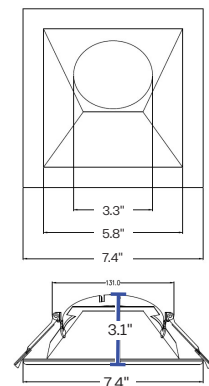

MOUNTING PLATE DIMENSIONS

PLT-90387:

Length – 18.2"

Width – 12"

Punch Out Diameters:

- 3" Round – 3 1/32"
- 3.5" Round – 3 3/4"
- 4" Round – 4 32/25"
- 4" Round Wall Wash – 5 3/5"
- 6" Round or 6" Round Wall Wash – 6 7/10"
- 8" Round – 8 1/16"

Bar Width – 0.2"

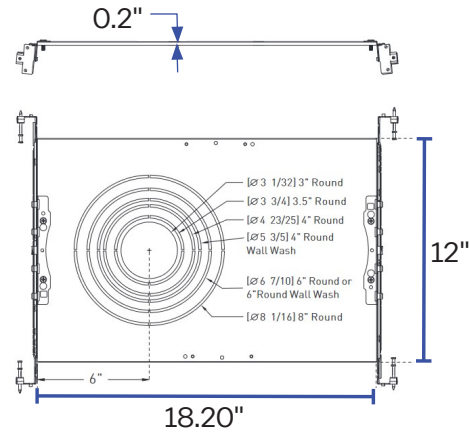

PLT-90388:

Length – 18.2"

Width – 12"

Punch Out Diameters:

- 4" Square or 4" Square Wall Wash – 5 1/2"
- 6" Square or 6" Square Wall Wash – 6 1/2"

Bar Width – 0.2"

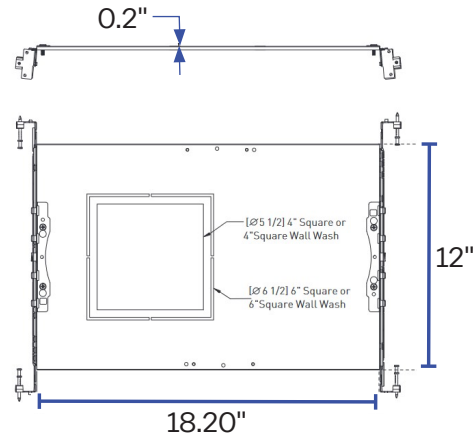

PLT-90600:

Length – 18.2"

Width – 12"

Punch Out Diameters:

- 3" Round – 3 1/32"
- 3.5" Round – 3 3/4"
- 4" Round – 4 32/25"
- 4" Round Wall Wash – 5 3/5"
- 6" Round or 6" Round Wall Wash – 6 7/10"
- 8" Round – 8 1/16"

Bar Width – 0.2"

PHOTOMETRICS

20W PHOTOMETRICS

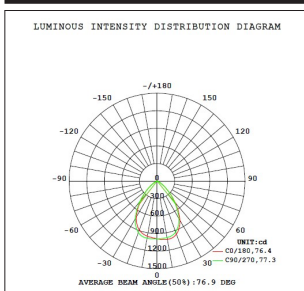

40W PHOTOMETRICS

