

55176

LED 2x2 DIMMABLE PANEL / 40W

TECHNICAL DATA SHEET

FEATURES



INDOOR LUMINAIRES

LED panels provide smooth glare-free illumination and uniform edge-to-edge light distribution for a clean, modern look. Simple installation; for use in drop ceilings or drywall.

- 0-10V dimming function, dimming range is 10% - 100%
- Hanging apparatus not included.

APPLICATION

Panels are the ideal energy-efficient replacements for fluorescent fixtures in offices, schools, hospitality, healthcare and other commercial and industrial applications.

SPECIFICATIONS

Power Consumption	40W
Input Voltage	120-277V
Power Factor	0.9
Lumens	3800
Luminous Efficiency	95 Lm/W
Color Temperature	5000K
CRI	83
Frame	White
Average Life	50,000
Dimension (Inches)	23.7"(L) x 23.7"(W) x 0.5"(H)



DIMENSIONS

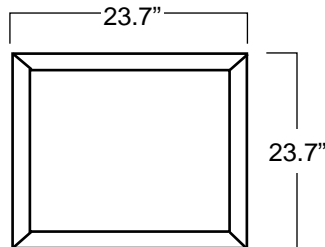

ORDERING

ITEM#	DESCRIPTION	WATT	COLOR	LUMENS	CRI	VOLT	HOURS	FRAME	CASE
55176	LED 2X2 PANEL 40W/50K/120-277V/DIMMABLE/V4 - SL® DLC	40	5000K	3800	83	120-277V	50,000	WHITE	2