

4" Die-cast Deep Round Reflector Trim for PAR LAMPS



4" die-cast deep round reflector trim. For use with PAR Lamps.

Features

- 4" Deep Round Reflector
- Lamp: For use with PAR Lamps.

Technical Details

Construction: Diecast aluminum with a powder-coated finish.

Compatible Housing: Compatible with 4" IC and Non-IC Housings (non-shallow).

Lamp: For use with PAR Lamps.

Options



White



Bronze

Dimensions

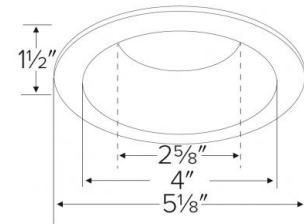

Product Numbers

Item	Finish
ELL4817W	All White
ELL4817BZ	All Bronze

Product Number Builder Example: ELL4817W

4" Round Deep Reflector Trim

Finish

ELL4817

- W** All White
- BZ** All Bronze

Compatible Products

For use with 4" Trims for PAR Lamps

4" Line Voltage ICA Housings

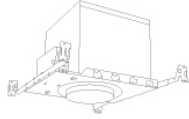

4" Airtight IC Housing
Double Wall Construction

CAT NO.	SPECIFICATIONS
EL99ICA	Lamp: 50W MAX.



4" Airtight Housing
New Construction

CAT NO.	SPECIFICATIONS
EL99A	Lamp: 50W MAX.



4" Airtight IC Housing
New Construction

CAT NO.	SPECIFICATIONS
EL99LDICA	Lamp: LED 12W MAX.



4" Airtight IC Housing with GU24 Base Socket
New Construction

CAT NO.	SPECIFICATIONS
EL99ICA-G24	Lamp: 18W MAX.



4" Airtight IC 2-Hour Fire Rated Housing
New Construction

CAT NO.	SPECIFICATIONS
EL99FICA	Lamp: 35W MAX.

4" Accessories



Fire Cover

CAT NO.	SPECIFICATIONS
FIRECVR	9 3/4" H x 17" O.D.

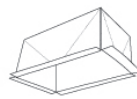

Fire Enclosure

CAT NO.	SPECIFICATIONS
FIREENCL	20 3/8" L x 14 3/8" W
FIREENCL-S	Shallow, 16" L x 14 3/8" W



Mica Fire Tape

CAT NO.	SPECIFICATIONS
FIRETAPE	3/4" W x 16' L