



COLOR/WATTAGE SELECTABLE GOOSENECK LED WALL SCONCE

WARNING, CAUTION, SAFETY AND INSTALLATION INSTRUCTIONS

WARNING

- Installation, service, and maintenance of luminaires should be performed by a qualified licensed electrician.
- Read all instructions before attempting installation.
- To avoid electric shock or component damage, disconnect power before attempting installation or servicing.
- Disconnect fixture and allow for cooling prior to servicing.

CAUTION

- Any alteration or modification of this fixture is forbidden as it may cause personal injury, death, property damage, and/or fixture malfunction.
- This luminaire is designed to operate in ambient temperatures ranging from -40°C to 45°C (-40°F to 113°F).
- MIN 75°C SUPPLY CONDUCTORS
- Consult a qualified electrician to ensure correct branch circuit conductor.
- Do not adjust the wattage and/or color temperature while fixture is powered on.
- Caulk mounting surface at all sides.

List of Materials



Fixture Body
1 pc



Mounting Base
1 pc



Wire Nuts
5 pcs



Butterfly Screw
Bolt
1pc



M4 Mushroom Head
Phillips Screw
2pcs

List of Tools (Not Included)



Wrench * 1pc
(1.28mm) wrench for M4 screws



Phillips screwdriver * 1pc

Installation Instructions

Surface Mounting (Internal Junction Box)

1. Turn OFF the main power from the breaker panel. Unscrew the cap nuts from the front of the mounting base. Remove the mounting plate from the back of the mounting base and set the mounting base and cap nuts aside (Fig 1).
2. Align the opening of the mounting plate with the opening of the internal junction box, ensuring the pre-installed screw threads are pointing outward. Use a drill or screwdriver to install the 2 included screws into the thread holes of the internal junction box (Fig 2).

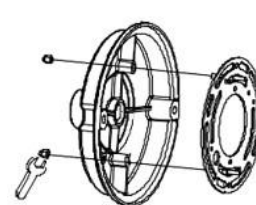

Fig 1

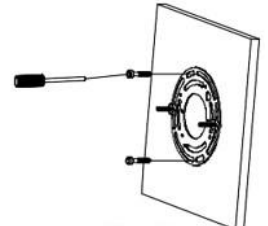

Fig 2



COLOR/WATTAGE SELECTABLE GOOSENECK LED WALL SCONCE

WARNING, CAUTION, SAFETY AND INSTALLATION INSTRUCTIONS

3. Thread the wires coming out of the neck through the mounting base, then thread the neck onto the mounting base (Fig 3, A). Secure the neck to the lampshade with the butterfly bolt (Fig 3, B).

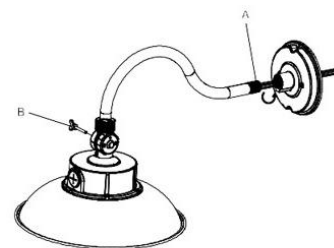

Fig 3

4. Complete the connections according to the Wiring Diagram. Connect the L (live), N (neutral), and ground wires in accordance with local and/or national electrical codes. Push the wiring into the internal junction box ensuring no wires are left exposed (Fig. 4).

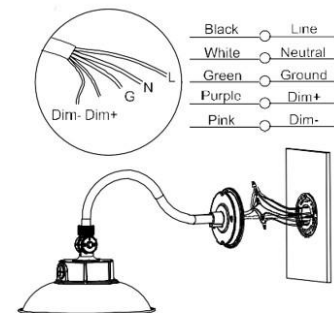

Fig 4

5. Insert the protruding screw threads through the screw holes of the mounting base. Secure the fixture using the 2 cap nuts removed in Step 1 (Fig 5). Loosen the butterfly bolt to adjust the angle of the lampshade as needed then re-tighten. Select the desired CCT, wattage, and photocell settings before restoring power (see CCT & Wattage Selectable Guide section).
6. Line the edge of the mounting base with waterproof sealant. Restore the main power (Fig 6).

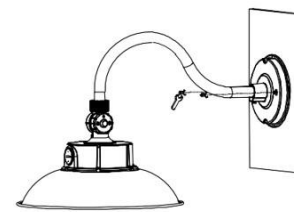

Fig 5

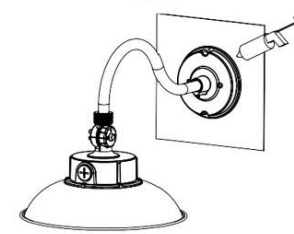

Fig 6

J-Box Mounting

1. Turn OFF the main power from the breaker panel. Unscrew the cap nuts from the front of the mounting base. Remove the mounting plate from the back of the mounting base and set the mounting base and cap nuts aside (Fig 7).
2. Align the opening of the mounting plate with the opening of the external junction box, ensuring the pre-installed screw threads are pointing outward. Use a drill or screwdriver to install the 2 included screws into the thread holes of the external junction box (Fig 8).

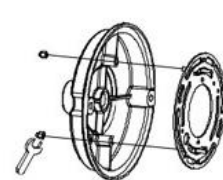

Fig 7

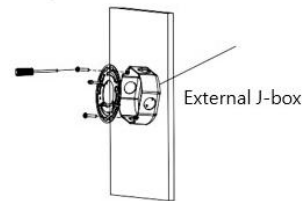
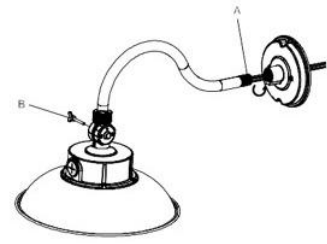
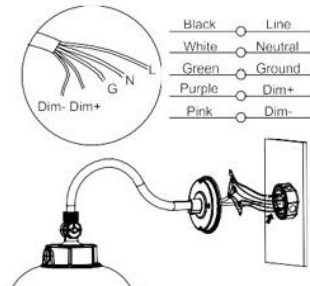
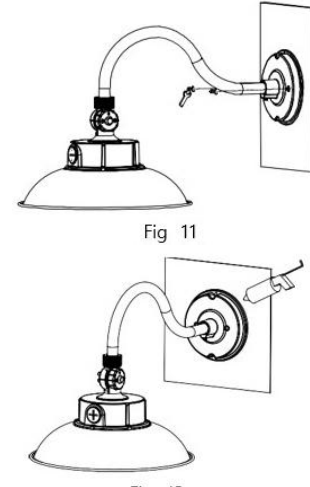

Fig 8



COLOR/WATTAGE SELECTABLE GOOSENECK LED WALL SCONCE

WARNING, CAUTION, SAFETY AND INSTALLATION INSTRUCTIONS

<p>3. Thread the wires coming out of the neck through the mounting base, then thread the neck onto the mounting base (Fig 9, A). Secure the neck to the lampshade with the butterfly bolt (Fig 9, B).</p>	 <p>Fig 9</p>
<p>4. Complete the connections according to the Wiring Diagram. Connect the L (live), N (neutral), and ground wires in accordance with local and/or national electrical codes. Push the wiring into the external junction box ensuring no wires are left exposed (Fig. 10).</p>	 <p>Fig 10</p>
<p>5. Insert the protruding screw threads through the screw holes of the mounting base. Secure the fixture using the 2 cap nuts removed in Step 1 (Fig 11). Loosen the butterfly bolt to adjust the angle of the lampshade as needed then re-tighten. Select the desired CCT, wattage, and photocell settings before restoring power (see CCT & Wattage Selectable Guide section).</p> <p>6. Line the edge of the mounting base with waterproof sealant. Restore the main power (Fig 12).</p>	 <p>Fig 11</p> <p>Fig 12</p>

Wattage & Color Temperature Selection

Remove the plug from the front of the fixture to reveal three DIP switches. Each DIP switch allows independent selection of color temperature (3000K/4000K/5000K), wattage settings (30W/40W/50W), or to turn the photocell ON/OFF. Ensure the plug is securely tightened after making selections to maintain waterproofing.

Note: Ensure power to the fixture is OFF before making adjustments.

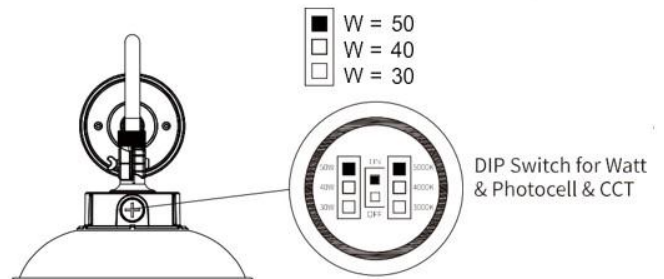



COLOR/WATTAGE SELECTABLE GOOSENECK LED WALL SCONCE

WARNING, CAUTION, SAFETY AND INSTALLATION INSTRUCTIONS

⚠ WARNING

- Before installing, servicing, or performing routine maintenance upon this equipment, follow these general precautions.
- To reduce the risk of death, personal injury, or property damage from fire, electric shock, falling parts, cuts/abrasions, and other hazards, read all warnings and instructions included with and on the fixture box and all fixture labels.
- Proper grounding is required to ensure safety.
- Power must be turned off at the breaker before installation or maintenance.
- This product must be installed in accordance with the applicable installation code by a person familiar with the construction and operation of the product and the hazards involved.
- Wear gloves and eye protection at all times while installing, servicing, or performing maintenance on the luminaire, and avoid direct eye exposure to the light source while it is on.
- To prevent wiring damage or abrasion, do not expose wiring to edges of sheet metal or other sharp objects.
- Do not install damaged product. Inspect luminaire for damage that may have occurred during transit. If damaged, contact the manufacturer immediately.
- These instructions do not purport to cover all details or variations in equipment nor to provide every possible contingency to meet in connection with installation, operation, or maintenance. Should further information be desired or should particular problems arise which are not covered sufficiently for the purchaser's or owner's purposes, contact the manufacturer.

⚠ ADVERTENCIA

- Antes de instalar, reparar o realizar el mantenimiento de rutina de este equipo, siga estas precauciones generales.
- Para reducir el riesgo de muerte, lesiones personales o daños a la propiedad por fuego, descarga eléctrica, caída de piezas, cortes / abrasiones y otros peligros, lea todas las advertencias y instrucciones incluidas con y en la caja del dispositivo y todas las etiquetas del dispositivo.
- Se requiere una conexión a tierra adecuada para garantizar la seguridad.
- Se debe apagar la energía en el disyuntor antes de la instalación o el mantenimiento.
- Este producto debe ser instalado de acuerdo con el código de instalación aplicable por una persona familiarizada con la construcción y operación del producto y los peligros involucrados.
- Utilice guantes y protección para los ojos en todo momento durante la instalación, el servicio o el mantenimiento de la luminaria, y evite la exposición directa de los ojos a la fuente de luz mientras está encendida.
- Para evitar daños o abrasiones en el cableado, no exponga el cableado a bordes de láminas de metal u otros objetos afilados.
- No instale un producto dañado. Inspeccione la luminaria en busca de daños que puedan haber ocurrido durante el tránsito. Si está dañado, comuníquese con el fabricante de inmediato.
- Estas instrucciones no pretenden cubrir todos los detalles o variaciones en el equipo ni proporcionar todas las posibles contingencias a cumplir en relación con la instalación, operación o mantenimiento. Si desea obtener más información o si surgen problemas particulares que no están suficientemente cubiertos para los propósitos del comprador o propietario, comuníquese con el fabricante.