



Item#: **55043**
LED 48" NARROW STRIP FIXTURE
LED READY FIXTURE

FEATURES

- Use 30% less energy than a traditional fluorescent fixture
- Die formed, and rigidly fabricated
- LED ready with non-shunted sockets
- Designed for pendant or chain mounting, adjustable cable

APPLICATION

Ideal for larger warehouses, retail applications, commercial buildings and work areas.

ELECTRICAL

Lamp Type (not included)	T8
Number of Lamps	1
Voltage	120-277V

ENVIRONMENT

Operating Temperature	-4° ~ 122°F
Suitable Location	DAMP
Ingress Protection Rating	IP40

LIFESPAN

Warranty (Years)	2
------------------	----------

CONSTRUCTION

Housing	22 Gauge C.R.S
Reflector	86% MRO4 Aluminum
Base / Power Supply	Hard Wired
Finish	High Gloss Baked White Enamel

QUALIFICATIONS



* Operating temperature may vary depending on the lamps used.

Item#: **55043**
LED 48" NARROW STRIP FIXTURE

DIMENSIONS (Inches)

Length	48"
Width/Diameter	2.9"
Height	2.1"
Weight (Lbs)	--

Line drawings may not be to scale and are for general reference only.

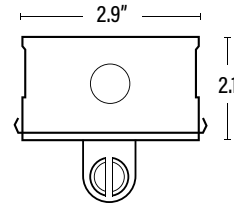
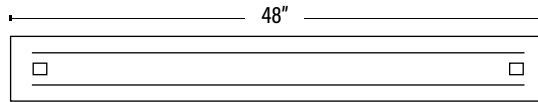

SUPPORTING DOCUMENTS (Grey = not available at this time.)

Product Sheet	VIEW
Install Instructions	VIEW
IES Download from Web Item	VIEW
LM79	VIEW
LM80	VIEW

PACKAGING

		UPC	DIMENSIONS (LxWxH)	GROSS WEIGHT (Lbs)
Master Carton	1	811768025880	--	--
Country of Origin	China			
HS Tariff	9405.10.6020			

ORDERING

ITEM#	DESCRIPTION	CASE
55043	LED 48" NARROW STRIP FIXTURE FOR 1/T8	1

ACCESSORIES/REPLACEMENT PARTS

54896	360° LED LOW/HIGH BAY FIXTURE PIR OCCUPANCY SENSOR 800W/1200W-120-277V - SUPERIOR LIFE®	50
54894	EXTENDER MODULE FOR SENSOR 54896/54897/54898 - SUPERIOR LIFE®	100

ADDITIONAL INFORMATION: